



TABLE-OF-CONTENTS

TABLE OF CONTENTS	-----	2
SUNLINE SELECT	-----	3
SUNLINE SELECT ELECTRIC	-----	13
UNIVERSAL ACCESSORIES	-----	27
SUNLINE SELECT ACCESSORIES	-----	36
SUNLINE SELECT KEY FEATURES	-----	41
FREQUENTLY ASKED QUESTIONS	-----	42
SUNLINE SELECT CERTIFICATIONS	-----	46



SUNLINE SELECT

WORKSTATION

HEIGHTS & WIDTHS

HEIGHTS:

- ➔ 1050 mm (41 in) *
- ➔ 1350 mm (53 in)
- ➔ 1650 mm (65 in)

*Factory Order

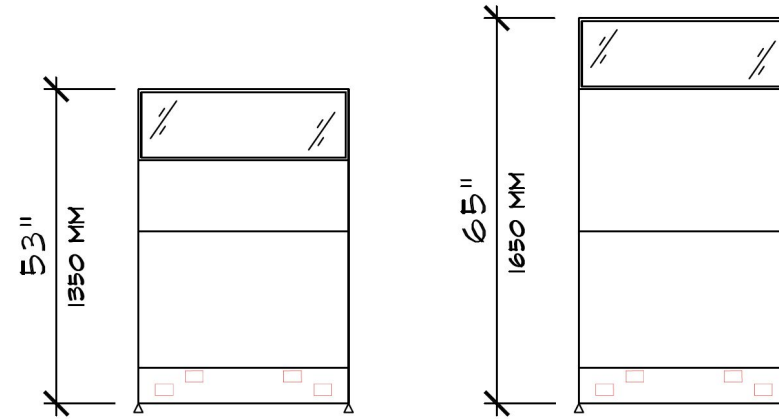

WIDTHS:

- ➔ 600 mm (2 ft)
- ➔ 900 mm (3 ft)
- ➔ 1000 mm (3.2 ft)
- ➔ 1200 mm (4 ft)

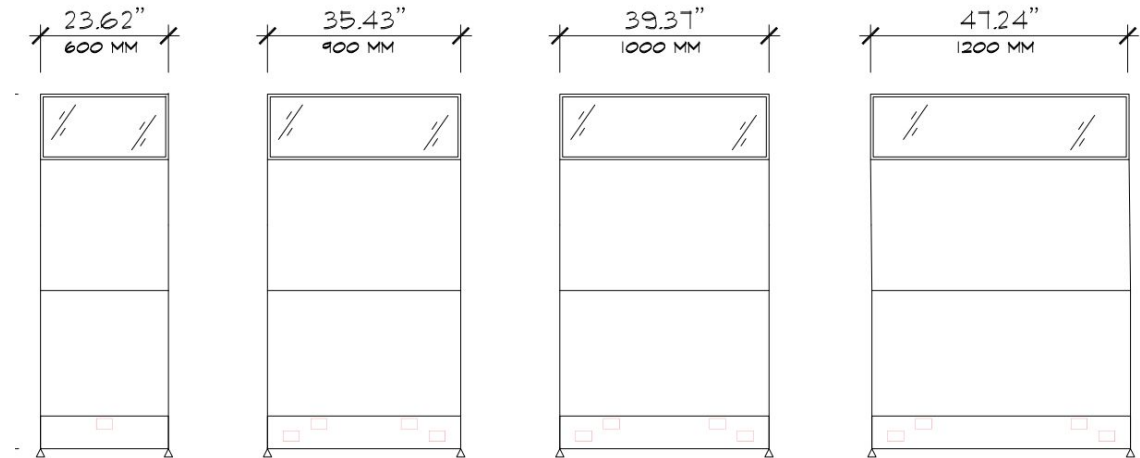

WORKSTATION HEIGHTS

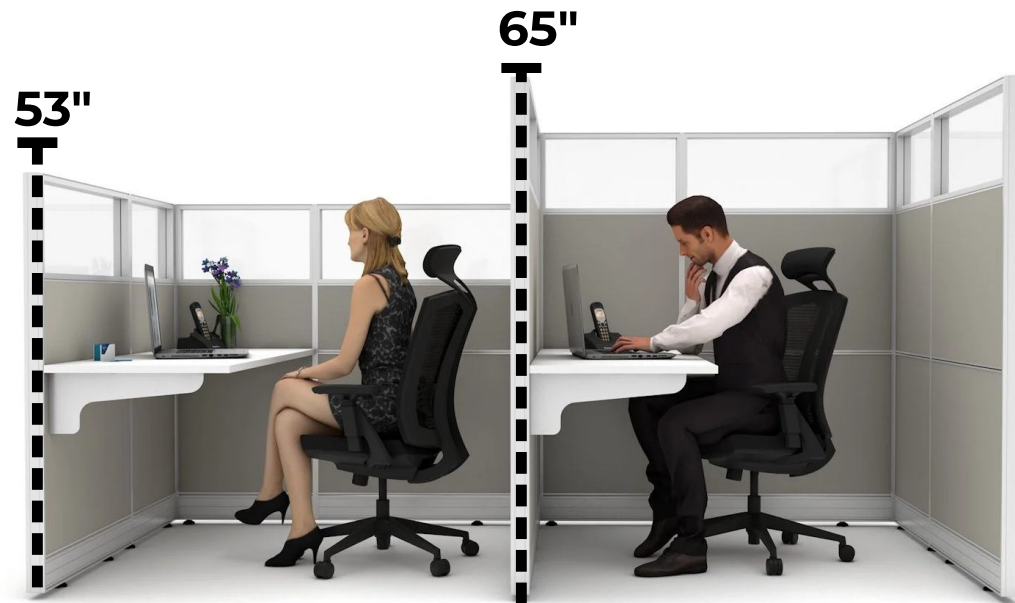

average male height: 5'9" (69")
average female height: 5'4" (64")

WORKSURFACE OPTIONS WITHOUT GROMMETS

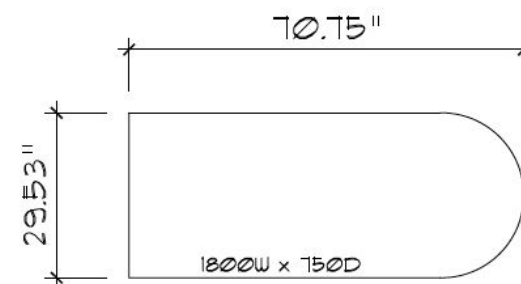
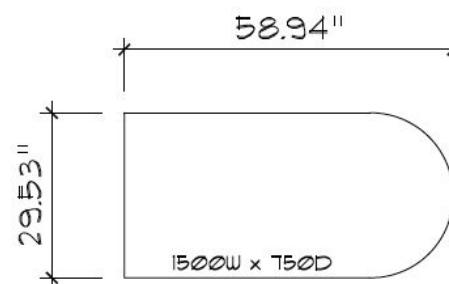
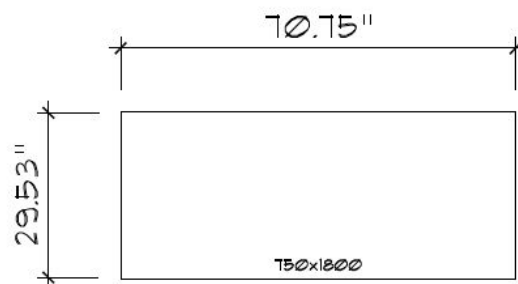
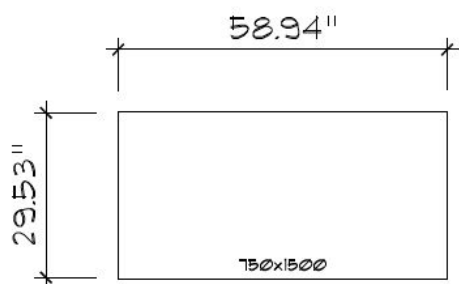
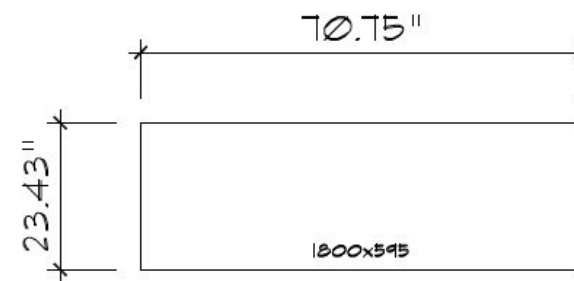
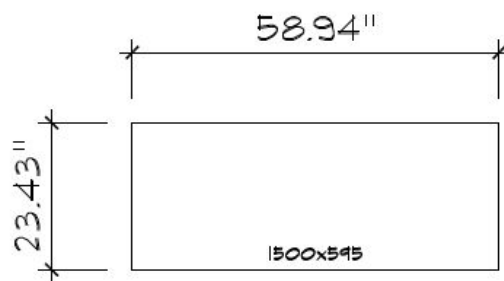
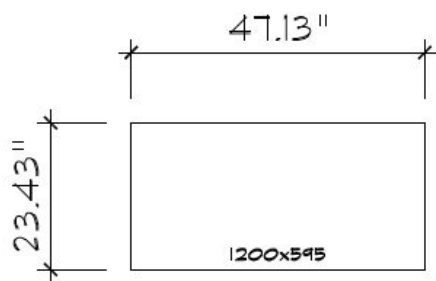
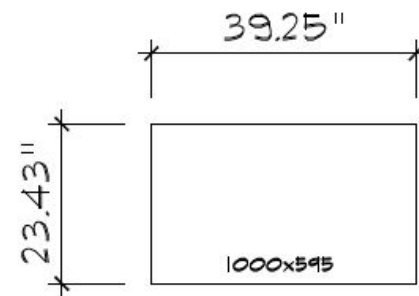
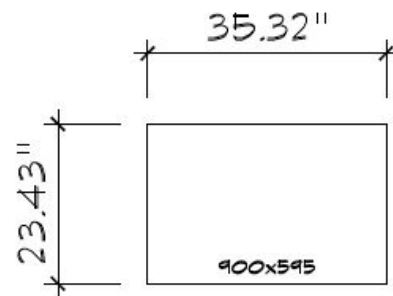
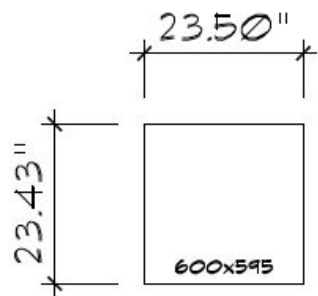

WORKSURFACE OPTIONS WITH GROMMETS

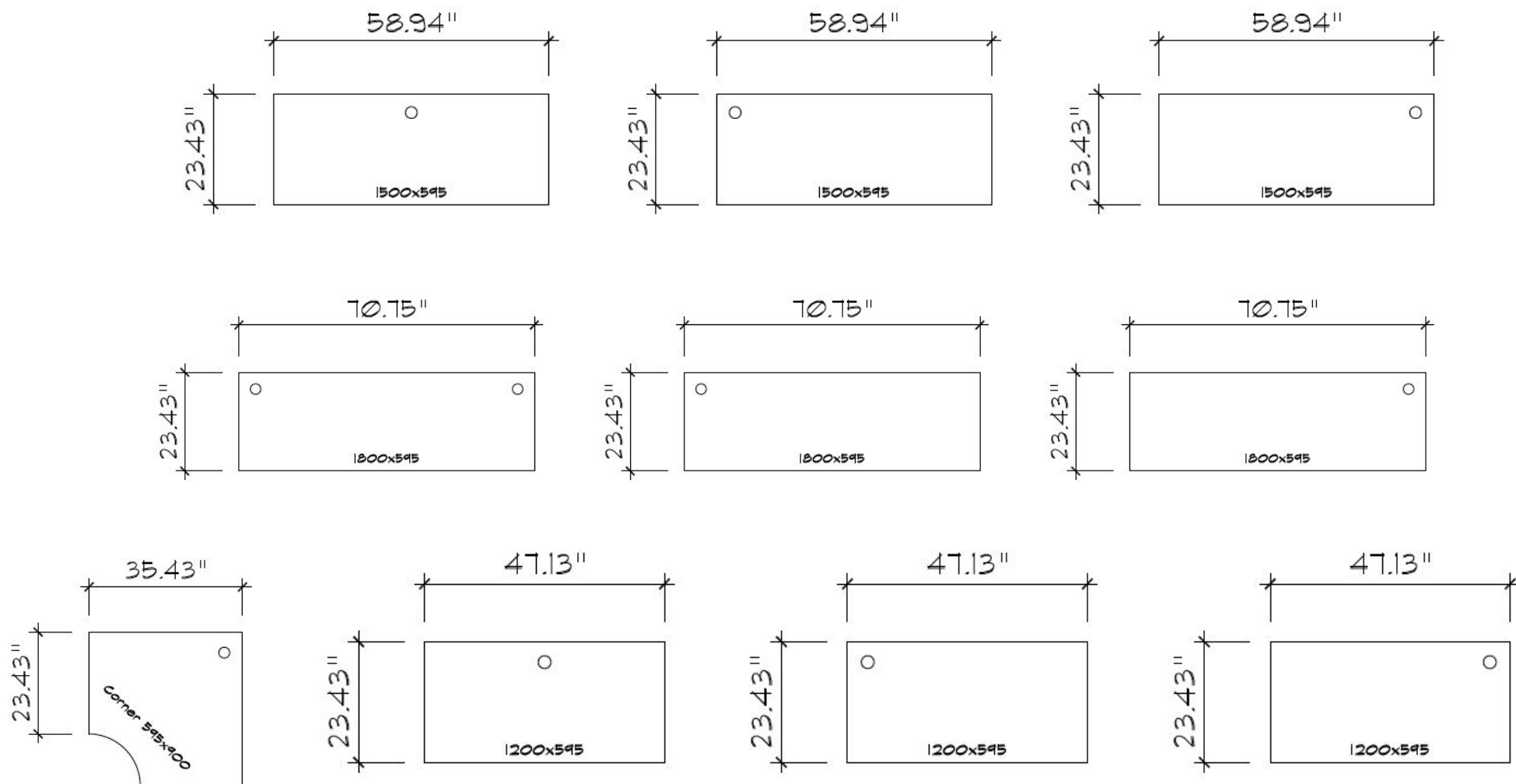

WORKSURFACE OPTIONS FOR SIT-STAND BASE

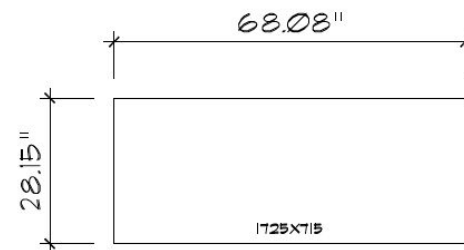
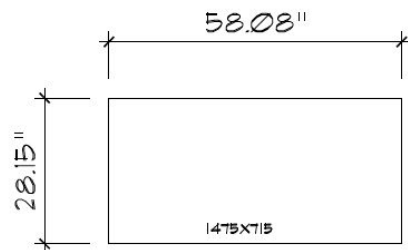
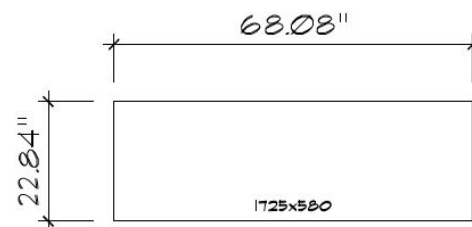
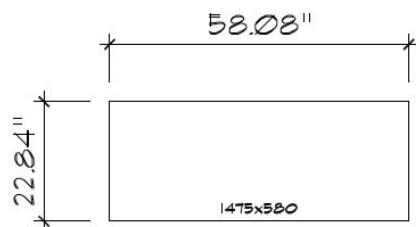
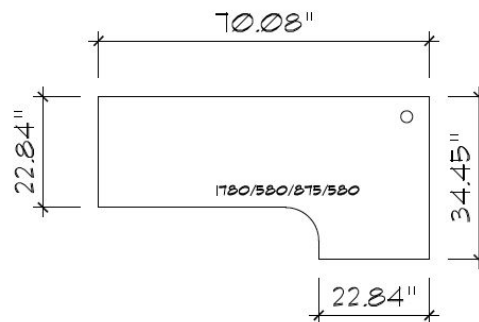
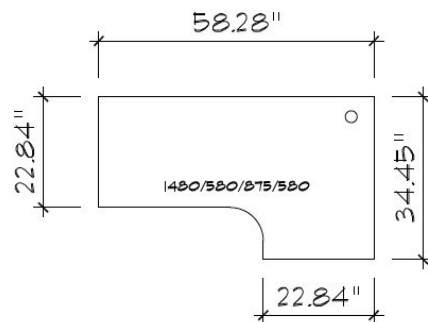

WORKSURFACE COMPOSITION

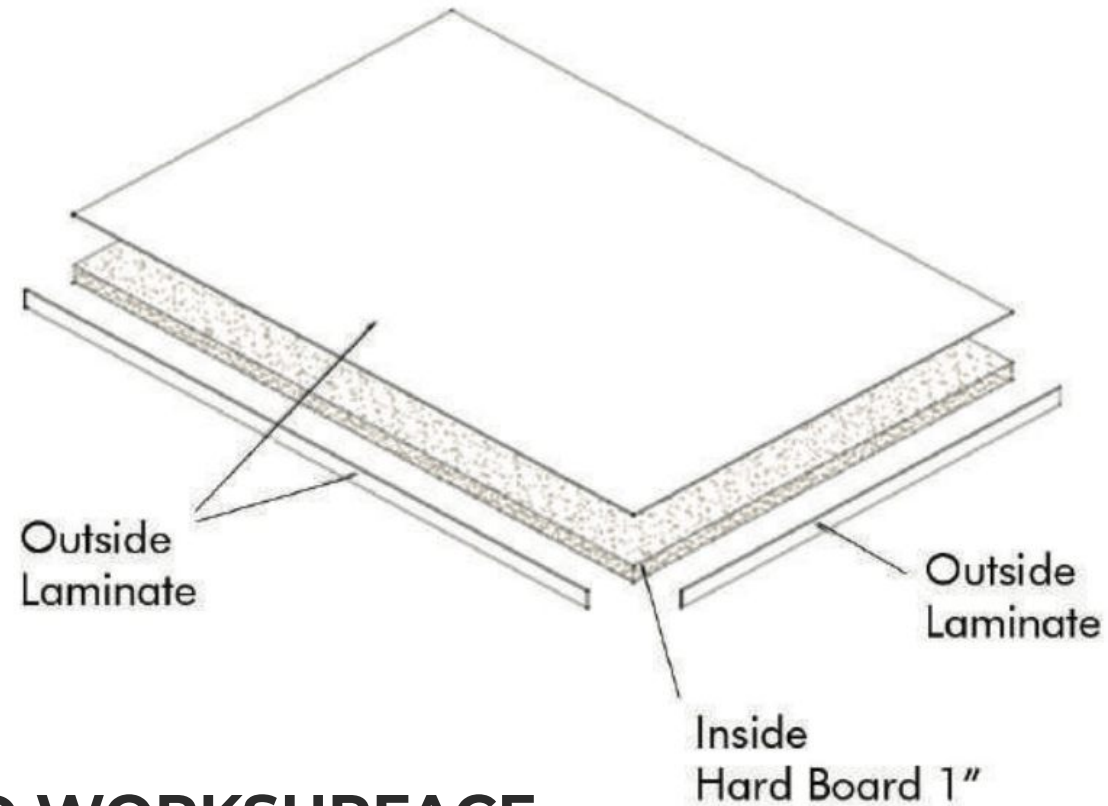

EXPLODED WORKSURFACE
(not to scale)

SUNLINE SELECT

IN-STOCK FINISHES

IN-STOCK / FABRIC



In- Stock:
Greige

IN-STOCK / TRIM



In-Stock:
UTOR - 05
(ANODIZED)

IN-STOCK / SURFACES



In-Stock:
White



In-Stock:
Walnut



In-Stock:
Grey Fog



In-Stock:
Storm Grey



FACTORY ORDER FINISHES

FACTORY ORDER / FABRICS*

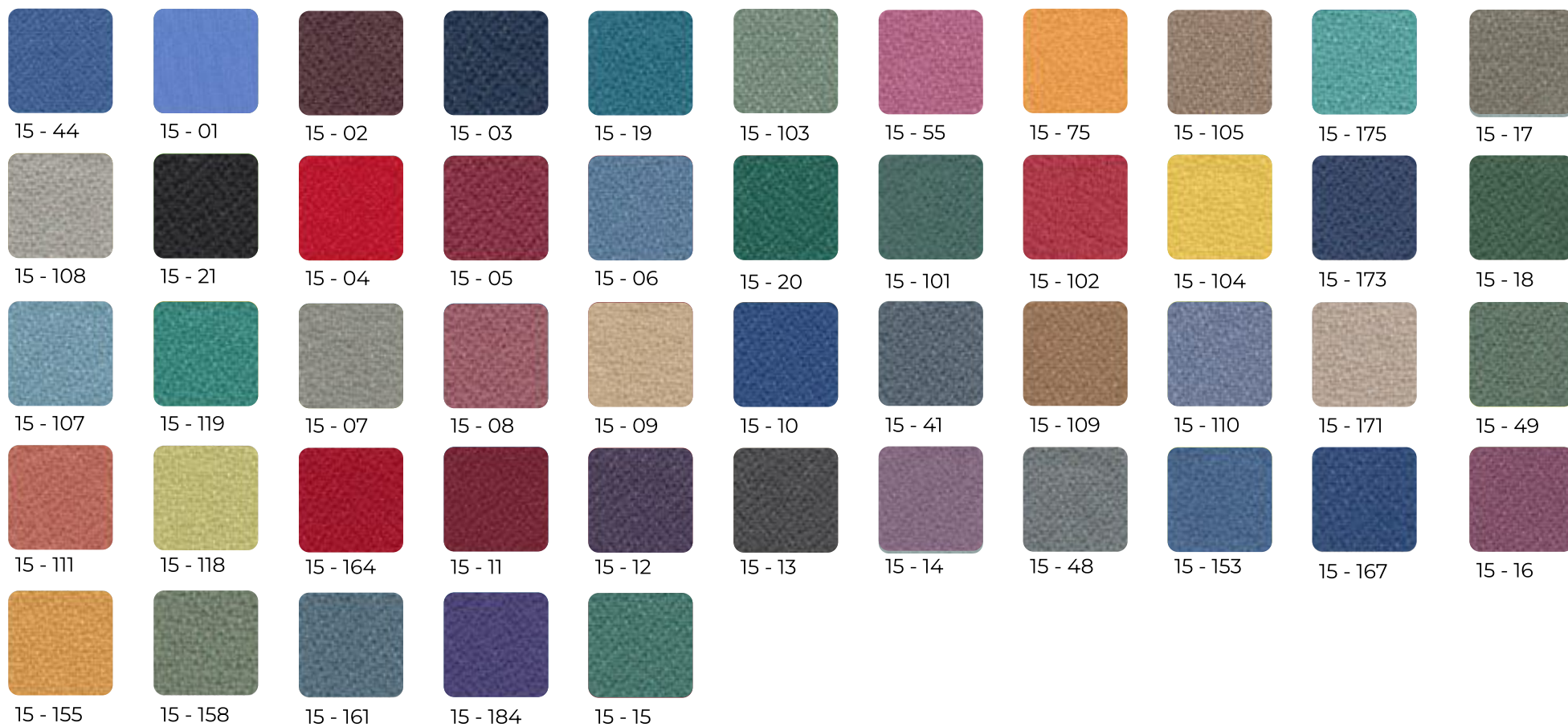

* Upcharge for Factory Ordered Colors

FACTORY ORDER FINISHES

FACTORY ORDER / SURFACES*



XD - 1001
Grey



XD - 1004
Black



XD - 1009
White



XD - 1014
Teak



XD - 1016
Walnut



XD - 1021
White Oak



XD - 1024
Engineered
Oak



XD - 1025
Black Oak



XD - 1026
Oak



XD - 1028
Red Walnut

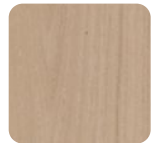

XD - 1037
Buller Thorn
Plum



XD - 1020
Maple



XD - 1021
Fir

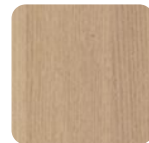

XD - 1022
Red Oak

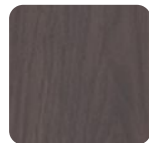

XD - 1040
North American
Walnut

FACTORY ORDER / TRIM*



F3



F1

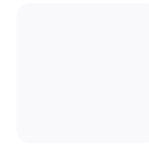

UTOR - 13

* Upcharge for Factory Ordered Colors

ELECTRICAL SPECIFICATIONS

Common Parts



Power Module

Allows a panel to be powered through the raceway.



Festoon

Connects one power module to another power module via posts.



Pass Thru Jumper

Spans non powered panels to continue power to another panel.



Base Feed

Connects the building's power from the wall or floor to the panels.



Ceiling Feed

Connects the building's power from the ceiling to the panels.

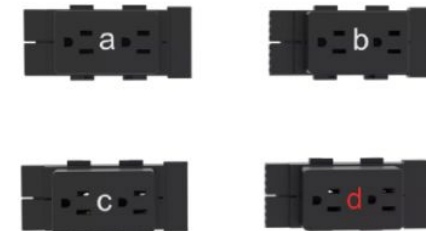

Receptacles

Outlets for cubicles.

ELECTRICAL SPECIFICATIONS

Power Modules provide electrical distribution and access for duplex outlets back to back. 24" wide panels can accept only one duplex outlet per side, two total back to back. All other panels can accept two per side, four total back to back. Power Modules "grow" in length with panels of greater width, making panel to panel connections a "standard" configuration and allowing for "pass through" connections. Each Power Module has locations for up to four jumpers, two at each end. Power Modules are included when ordering powered panels.

Duplex outlets are available on designated circuits 1 through 4. Each duplex outlet contains two single receptacles (places to plug into) of the same circuit and are specified separately from Power Modules. All duplex outlets have black faces. The lettering on outlets for Circuit 1, 2, and 3 is white. The lettering on outlets for Circuit 4 is orange. Outlets snap into the Power Modules. Duplex outlets are standard 15 amp outlets.

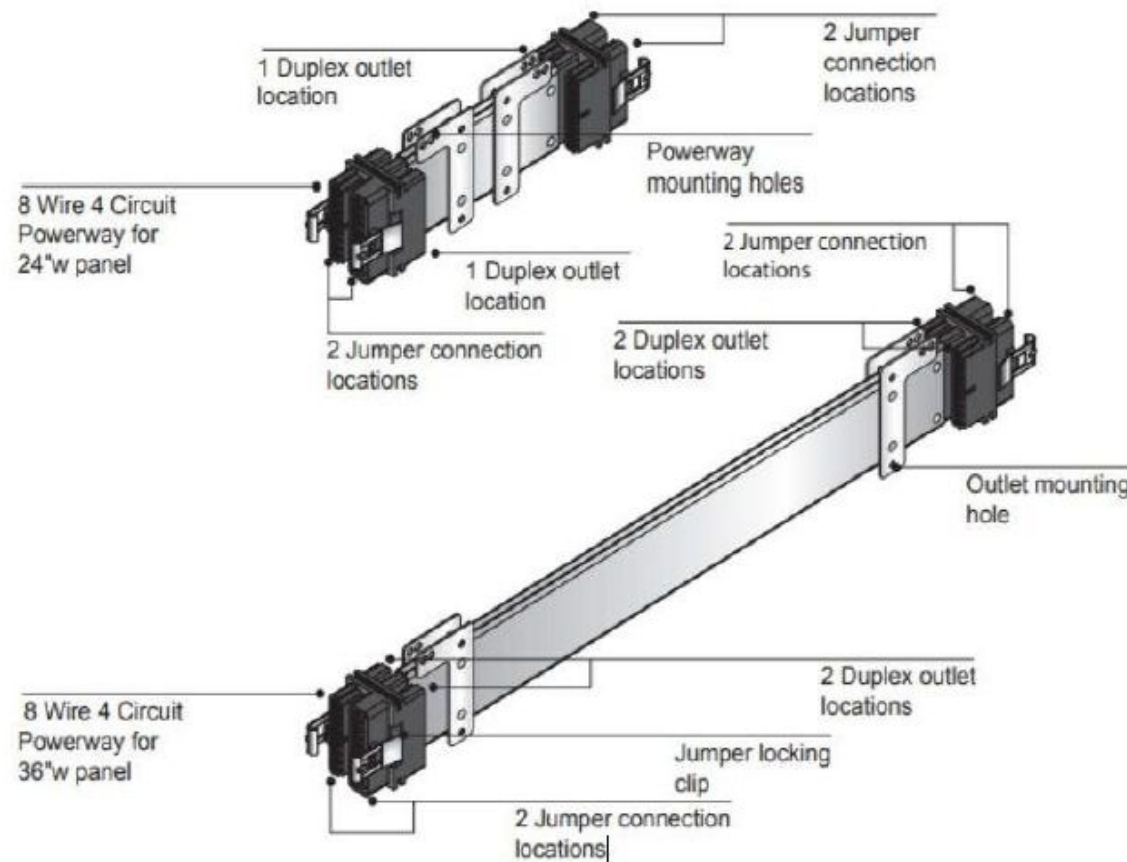

*Powerway = Power Module on graphic

ELECTRICAL SPECIFICATIONS

8 Wire 4 Circuit electrical system contains four circuits. Each circuit is rated at 15 amps/120 volts maximum. Circuit 1, Circuit 2, and Circuit 3 are served by a system neutral and an equipment ground. Circuit 4 is dedicated and is served by its own neutral and ground. Circuit and ground conductors are # A.G.W. (gauge).

All neutrals are #10 A.G.W. (gauge).

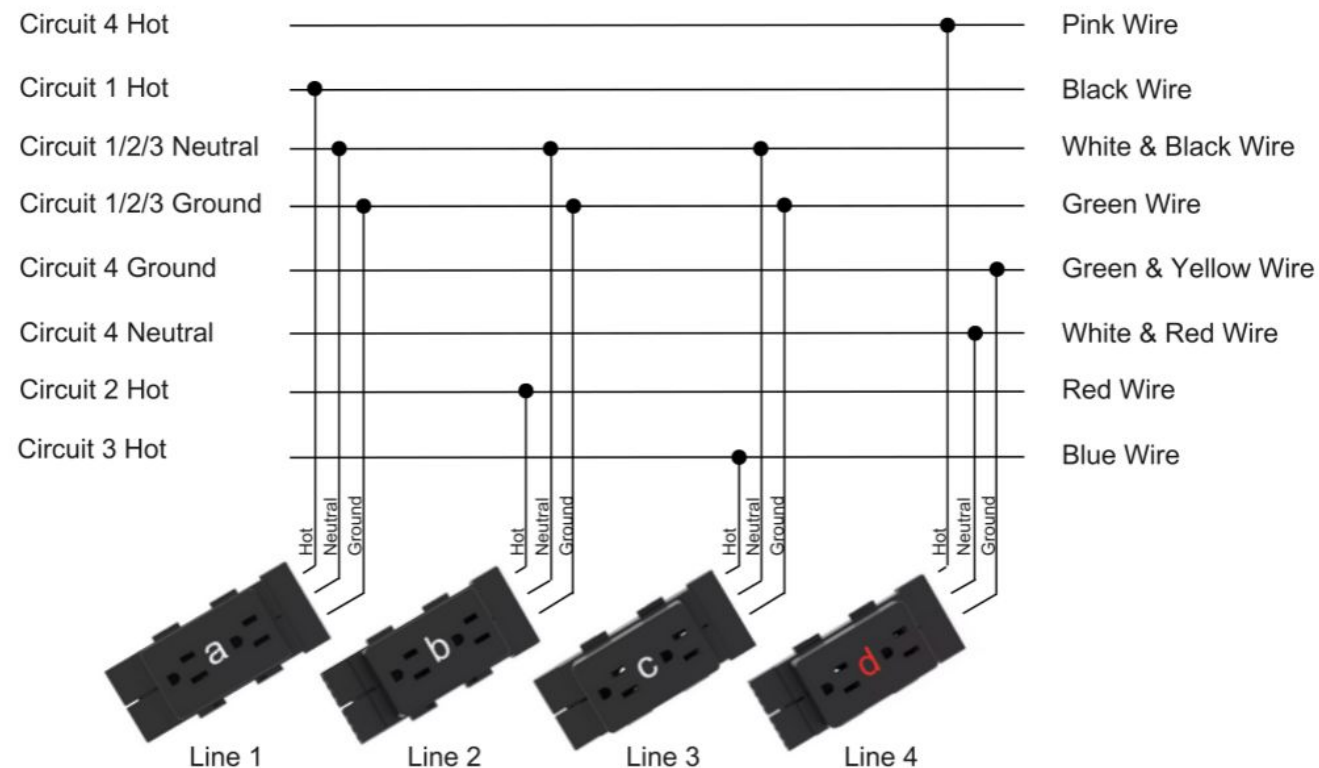

Note: Not all workstations contain all four duplexes. Refer to the project's electrical drawing for more details.

ELECTRICAL SPECIFICATIONS

Wiring Anatomy for Ceiling and Base Infeeds

Shown below is a cross section of the metal cable used for 8 Wire 4 Circuit ceiling and base infeeds.

Circuit and ground conductors are #12 A.G.W. (gauge).

All Neutrals are #10 A.G.W. (gauge).

Cross Section 8 Wire 4 Circuit Cable

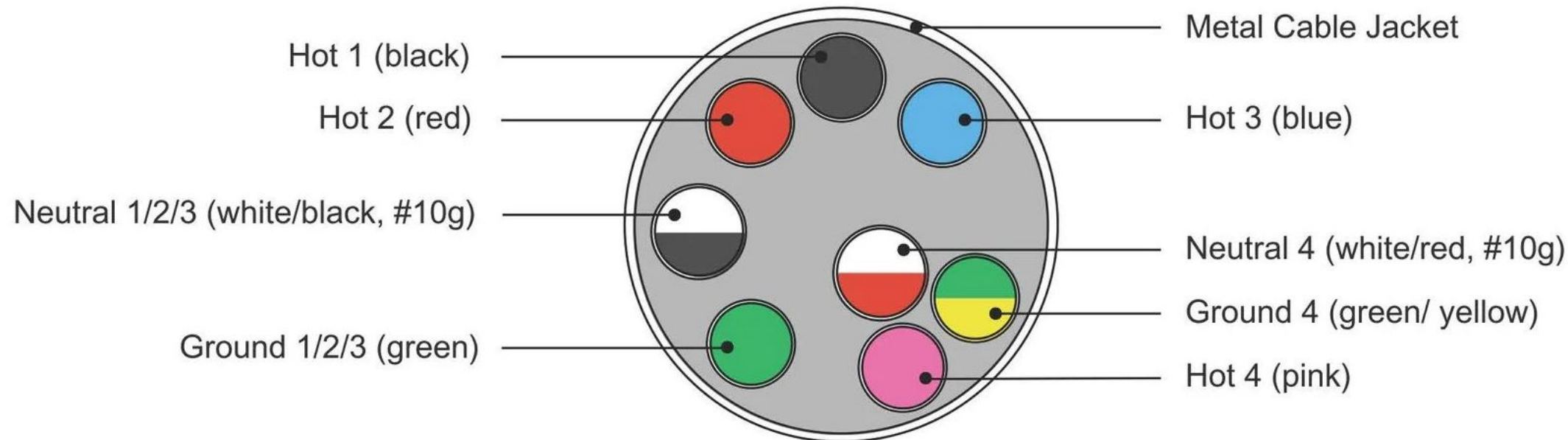

ELECTRICAL SPECIFICATIONS

This configuration includes 4 hot wires that correspond to circuits a, b, c, and d. Circuits a, b, and c are general circuits that share a common neutral and ground. Circuit d is considered an isolated circuit because it has its own grounding source and wire that is not shared with other equipment. Circuit d is also considered dedicated because it has its own neutral wire.

The purpose of having its own neutral and isolated ground is to prevent unwanted noise from other devices traveling through the system and potentially causing interruptions. Circuit d is typically reserved for computers. Because Circuit d has its own hot, neutral, and ground wires, it could have a separate source of power known as a UPS (Uninterrupted Power Source).

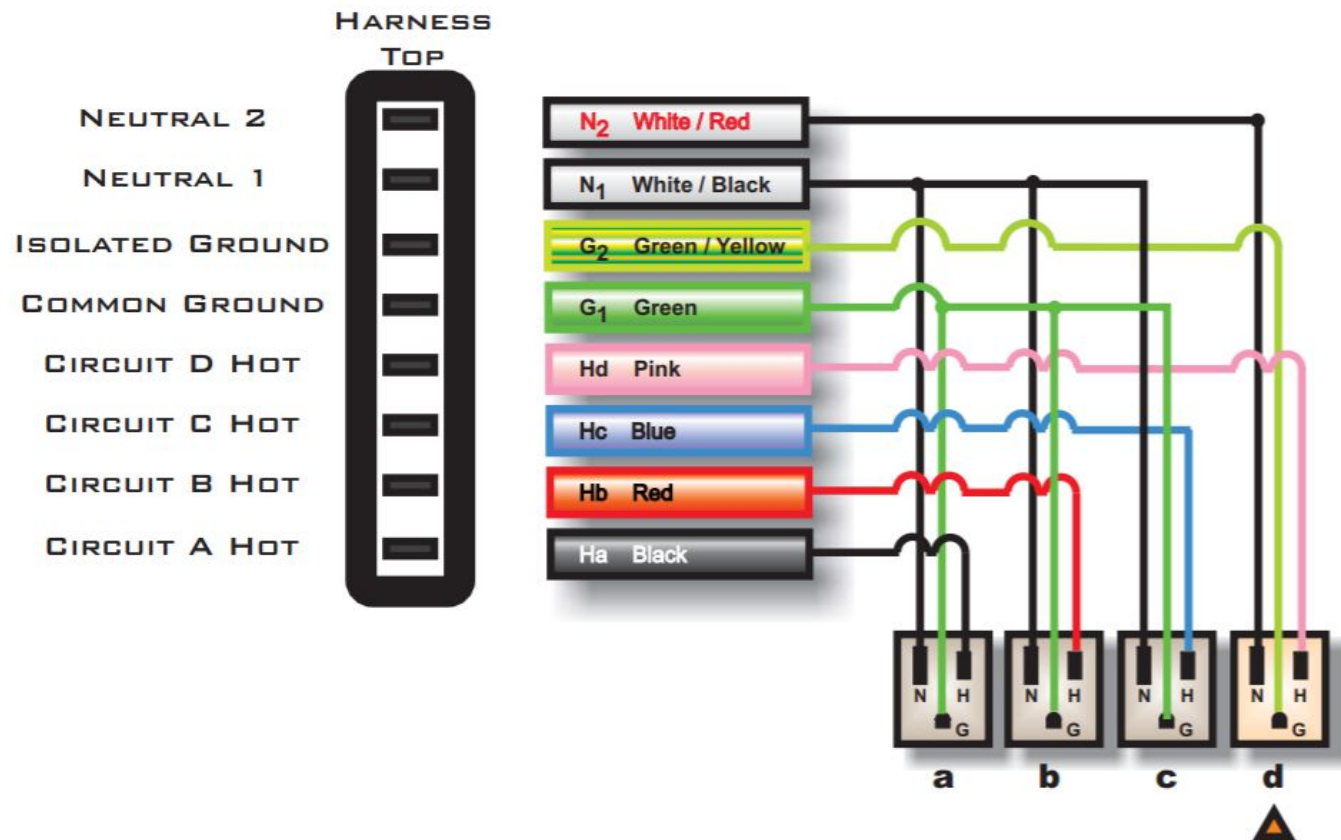

3 GENERAL PURPOSE + 1 ISOLATED CIRCUIT

ELECTRICAL SPECIFICATIONS

Typical Electrical Raceway (covered)



Typical Electrical Raceway (uncovered)

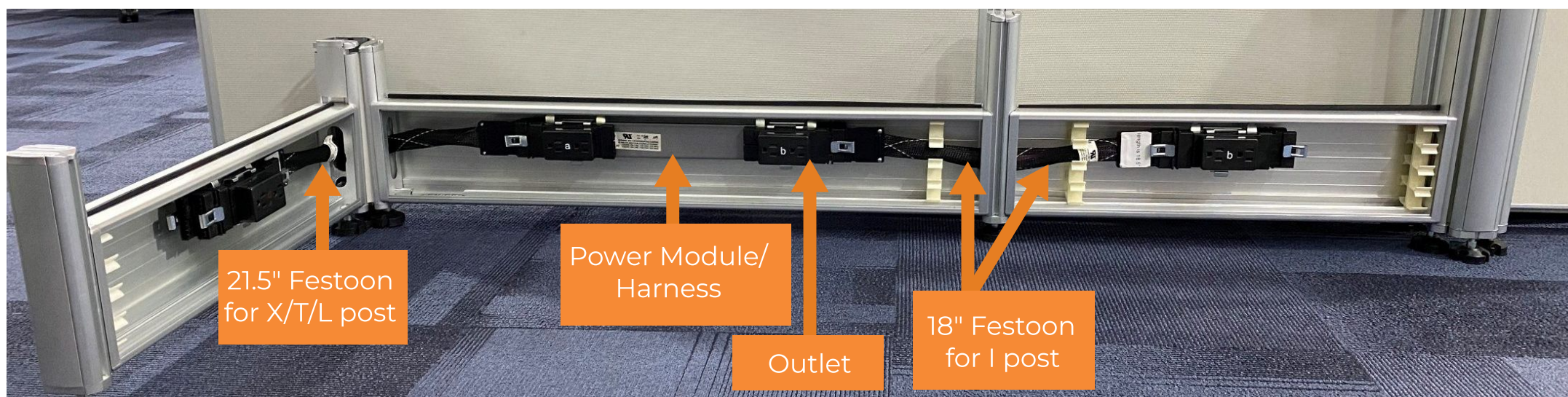

ELECTRICAL SPECIFICATIONS

Hiring an IT/Networking Team

Every company has very specific requirements when it comes to data/networking. When you hire a networking contractor, they will pull lines from the server room and splice their wiring into the networking jacks that fit your needs. Some require one jack per face plate, some require multiple. If electrical and data are coming from the ceiling and are being supplied to more than three workstations, we recommend that each data drop has their own power pole, separate from the power poles used for electrical.

To the right is an example of what a lot of clients use as a data face plate. Your IT Group should supply the data face plate and hardware that works best for your needs. Our raceway covers are silver and our electrical receptacles are black.

The rectangular cutout is simply a "knockout" in the raceway cover at the base of the panels where your networking contractor can attach any size flush mount plate. This knockout will need to be punched out during install. Any size will work (larger than the knockout) and you can screw it right to the raceway cover.

Data Plate Specifications

Standard kickplates (for 900mm, 1000mm, 1200mm raceways) will have two knockouts/cutouts. The data knockout is 2x2 (50.8 mm) and 1 ½" (38.1 mm) from the bottom of the kick plate.

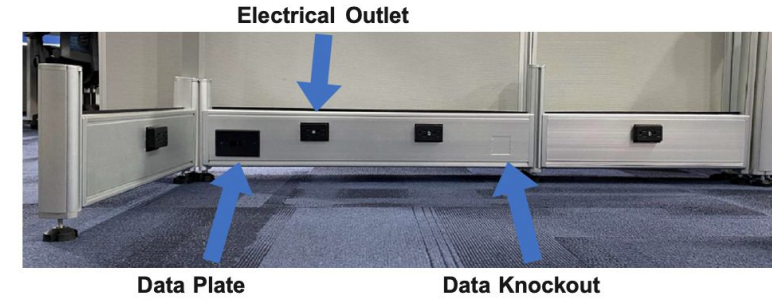

Data Plate - outside view



Data Plate - inside view

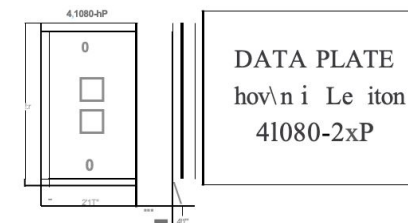

ELECTRICAL SPECIFICATIONS

Ceiling Infeeds

Power can be brought from the ceiling down to the workstations via a power pole. This plastic pole slides 6" down into the post (t-post or x-post) of the workstations panels, and can power up to eight workstations.

The standard height of the pole is 12', and it can be cut ahead of time if the ceiling height is known. If not, it can be cut in the field. The infeed inside of the power pole is 14' long, leaving 1' on either end to connect into the building's power and to the workstation power harness.

The first 4.5' of cabling within the power pole will be covered by metal flex casing. If the cabling needs to be protected up to the ceiling, you can ask your electrician to provide an M3 braided jacket, which can attach to the junction box. Your electrician would need to determine where the cut out in the ceiling should be located based on the location of the workstations.

If electrical and data are coming from the ceiling, we recommend that each data drop has their own power pole, separate from the power poles used for electrical.



Ceiling power pole when installed

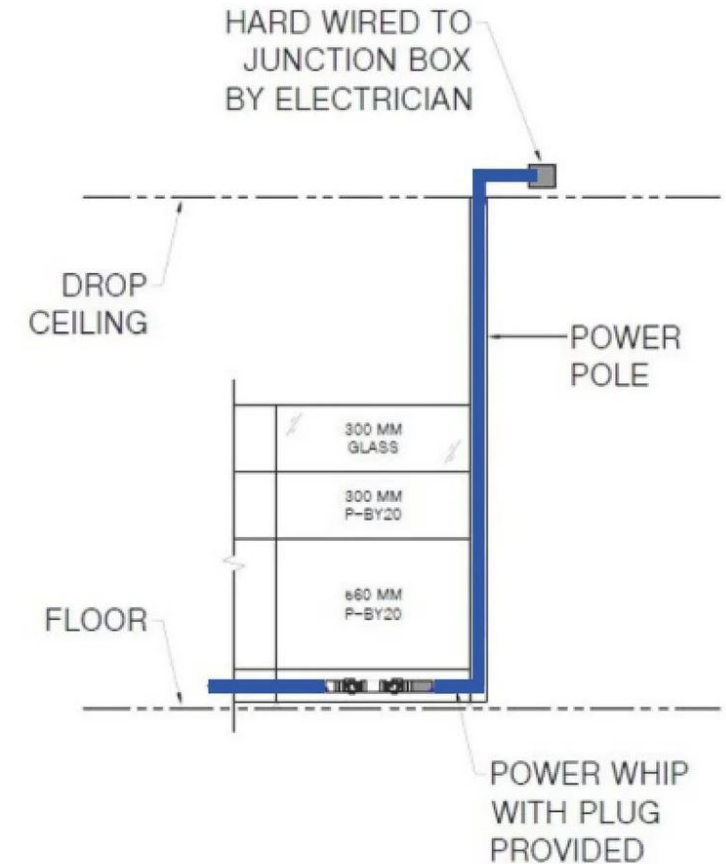

Ceiling infeed diagram

ELECTRICAL SPECIFICATIONS

Base Infeeds for Walls & Floors

Power can be brought from the wall or the floor via a base infeed (also known as a whip). These infeeds are 6' long and can support up to eight workstations. One end of the infeed will plug into the workstation panels, while the other end will need to be hardwired into the building's power.

If infeeds are sent out prior to install to be used on the wall, please have your electrician install them with a 90 degree elbow and have the whip pointing towards the ground, as shown in the first image. The hardware for attaching an infeed to the floor or wall will need to be provided by your electrician.



Example of wall infeed



Example of floor infeed



Power Infeed
(Whip)

Infeed connection inside of panel, with exposed wiring on other end to hardwire into wall or floor

ELECTRICAL SPECIFICATIONS

Base Power Infeed (left and right)

Also called wall infeed or power whip, base infeeds are connected by an electrician to a main electric line in the wall or floor, and into a power module that's mounted to a raceway, which begins the electric current all around raceways in the cubicle walls as long as they're connected through festoons/connectors, pass through jumpers, and/or other power modules. To be safe, one base infeed can power up to 8 cubicles.

Celing Power Infeed

Ceiling infeeds are connected by an electrician to the main electric line in the ceiling, down through a power pole, and around into a power module that's fastened to a raceway, which starts the electric current all around raceways as long as they're connected through festoons/connectors, pass through jumpers, and other power modules. To be safe, one ceiling infeed can power up to 8 cubicles.

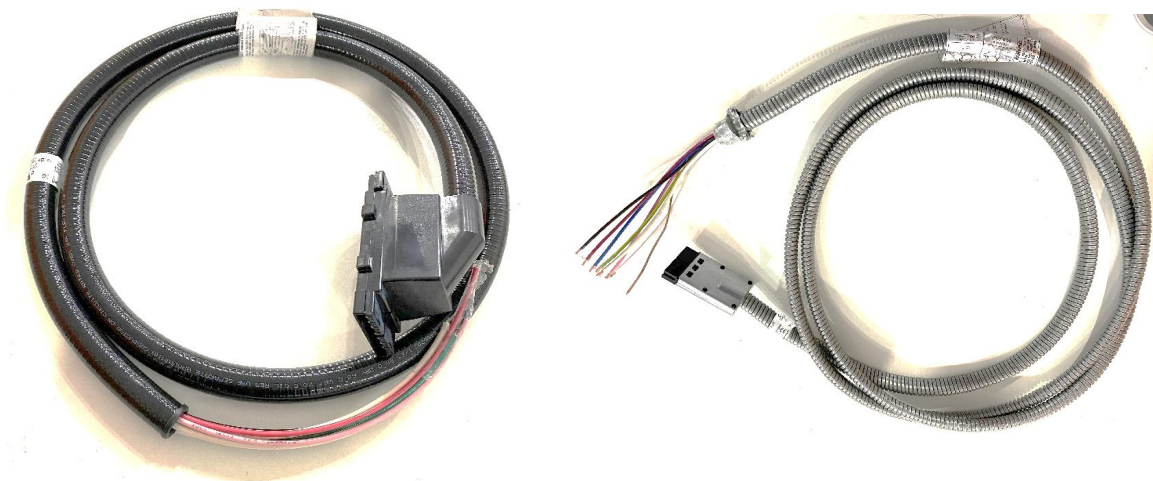

Arrow is up and wire coming out on the left side indicates this is a left infeed

ELECTRICAL SPECIFICATIONS

POWER MODULE

In 3 standard sizes – 23.62" (600mm raceway), 35.43" (900mm raceway), and 47.24" (1200mm raceway), power modules receive power from the base/wall infeed, ceiling infeed, or floor core infeed, to power receptacles (outlets) that clip in. Also available in 39.4" for 1000mm raceways.



RACEWAY

The raceway is typically the bottom-most “panel” and allows for electric to run into every cubicle requiring power. It typically comes in 3 sizes: 600mm*150mm, 900mm*150mm, 1200mm*150mm. Also 1000mm*150mm when a door is used.

Inside each raceway is either a power module that’s been mounted to the raceway, or a pass-through jumper that passes the electric from one power module to the next. A raceway is not used if neither a pass-through jumper runs through it, or there is no power module. Receptacles - aka outlets or duplexes - clip into power modules and through cut out holes in kickplates.

Raceways can also run above the work surface - called beltway power - but this is very uncommon since it means all the wires and cords would be out in the open.



ELECTRICAL SPECIFICATIONS

RECEPTACLES / POWER OUTLETS

There are 4 lettered designations of standard receptacles: A, B, C, D. Although there are slight differences in how each is wired internally, the letters are primarily reference points for the electrician to help him/her keep track of how to combine various receptacles of the same letter into one group of connections that all lead to their dedicated 15 amp breaker.

While each receptacle can draw up to 15 amps, typically each cubicle will draw 3-5 amps at any given point in the day - distributed into however many receptacles are being used and how users plug in their electronics (i.e. - computer in one receptacle, all other accessories in another).

Electricians should wire matching letters together to reach the breaker's 15 amp capacity (allowing up to 2.5 amps for each receptacle). If any one group of lettered receptacles (i.e. - all the A's) combines for more than 15 amps, then another infeed must be used.

Breaking it down further, if each letter uses 2.5 amps on average, then any one cluster can use up to 6 of that lettered receptacle (6 receptacles * 2.5 amps = 15amps). Which means, by evenly dispersing all 4 letters, the receptacles should be able to support up to a 12-pack of cubicles on one infeed plus 4 breakers.

Common Equipment Amperages:

- Personal Computer - 2.00 - 4.00
- Computer Monitor - .25 - .50
- Laser Printer - 4.50
- Desktop Plotter - 1.50
- Desk Fan - .50 - 1.00
- Desk Heater - 8.50 - 12.50
(Not recommended to use in cubicle)
- Task light - 1.00
- Fan - 1.00
- Paper Shredder - 4.00 - 12.00



ELECTRICAL SPECIFICATIONS

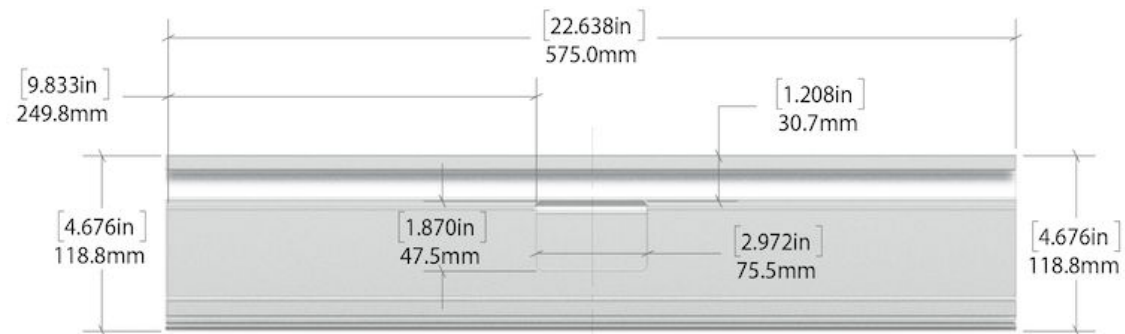

575W RACEWAY

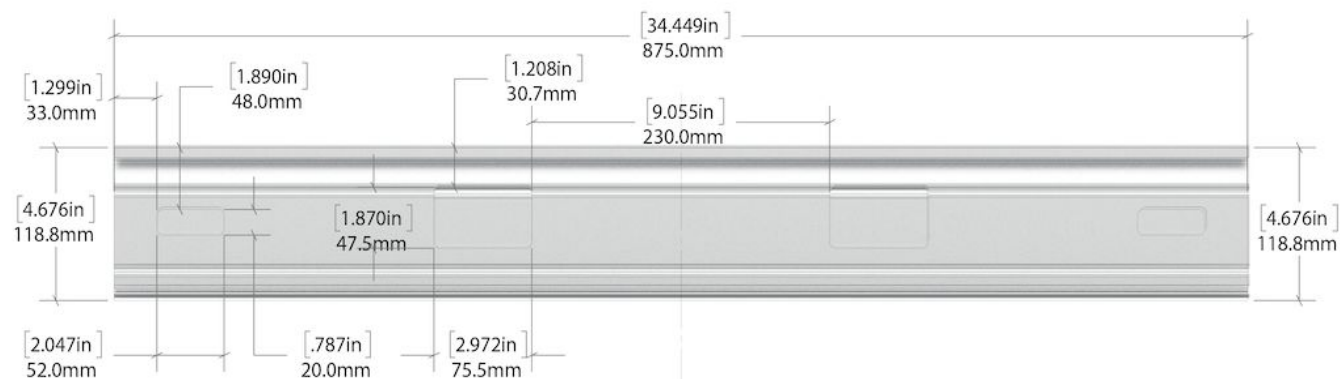

875W RACEWAY

ELECTRICAL SPECIFICATIONS

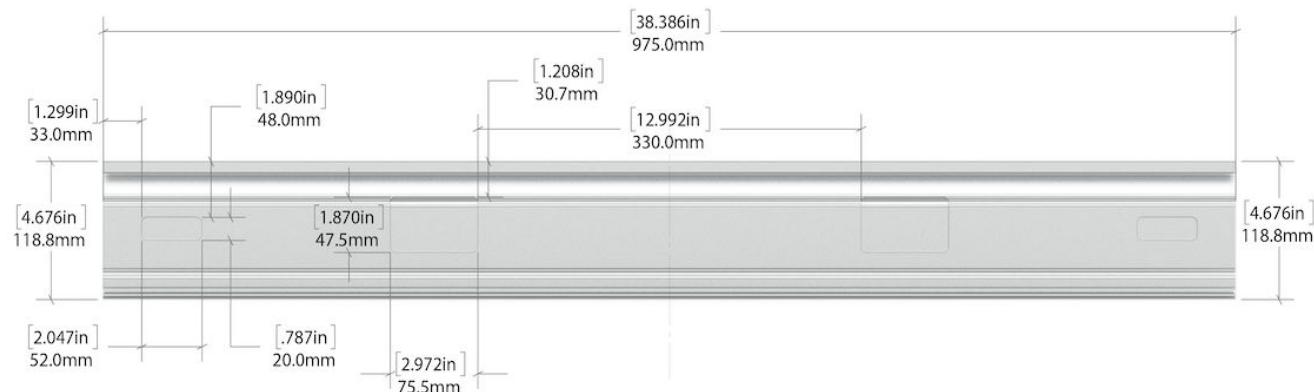

975W RACEWAY

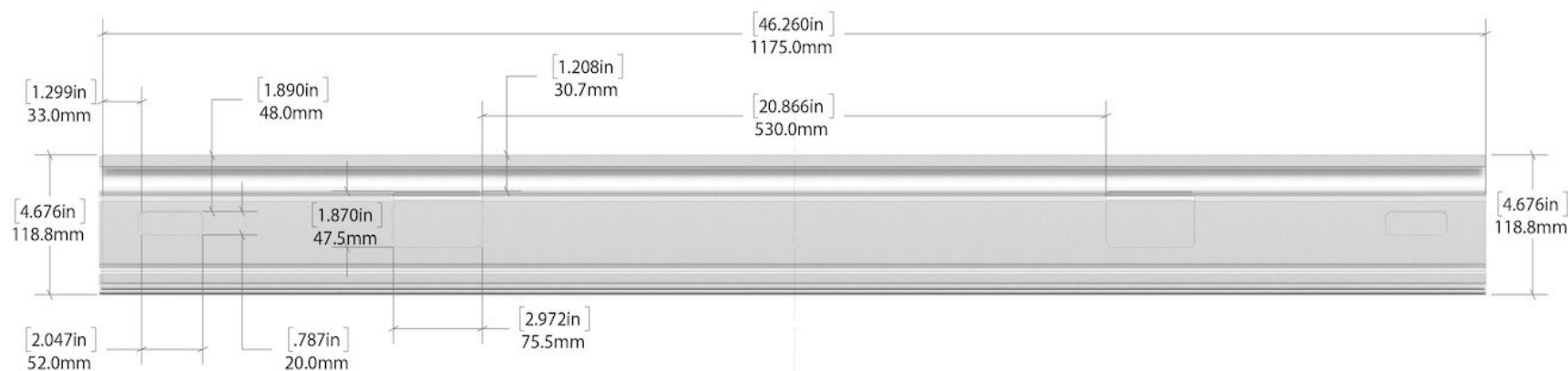

1175W RACEWAY

UNIVERSAL WORKSTATION ACCESSORIES

IN-STOCK / ACCESSORY FINISHES

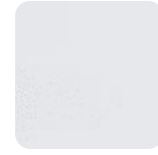

White



Walnut



Grey Fog



Storm Grey



Sit-Stand Base



2-Drawer Lateral
File



Box-Box-File



Monitor Arms



Wardrobe Cabinet



Storage Tower



Mobile Box-File



File-File

UNIVERSAL SIT-STAND DESK BASE

PRODUCT DIMENSIONS*

(A) WIDTH
40in - 72in

(B) DEPTH
22in

(C) HEIGHT
24in - 49in

*dimensions are for base only and do not include the surface

IN-STOCK / SURFACE FINISHES

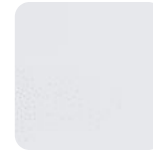

White



Walnut



Grey Fog



Storm Grey

*in-stock base color is white



UNIVERSAL LATERAL FILE TWO-DRAWER

PRODUCT DIMENSIONS

(A) WIDTH
30in

(B) DEPTH
23in

(C) HEIGHT
28in

IN-STOCK / ACCESSORY FINISHES

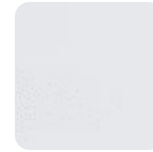

White



Walnut



Grey Fog



Storm Grey

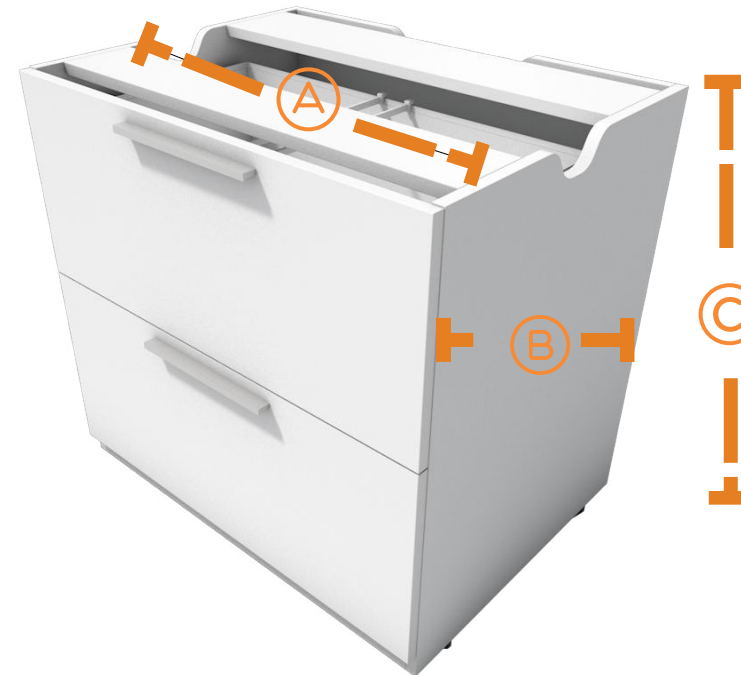

UNIVERSAL BOX-BOX-FILE STORAGE

PRODUCT DIMENSIONS

(A) WIDTH
16in

(B) DEPTH
23in

(C) HEIGHT
28in

IN-STOCK / ACCESSORY FINISHES

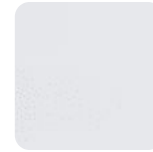

White



Walnut



Grey Fog



Storm Grey



UNIVERSAL DUAL MONITOR ARMS

PRODUCT DIMENSIONS

(A) WIDTH
29in

(B) DEPTH
5in

(C) HEIGHT
22in



UNIVERSAL WARDROBE CABINET

PRODUCT DIMENSIONS

(A) WIDTH
12in

(B) DEPTH
24in

(C) HEIGHT
53in

IN-STOCK / ACCESSORY FINISHES

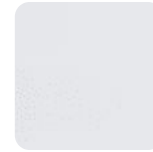

White



Walnut



Grey Fog



Storm Grey

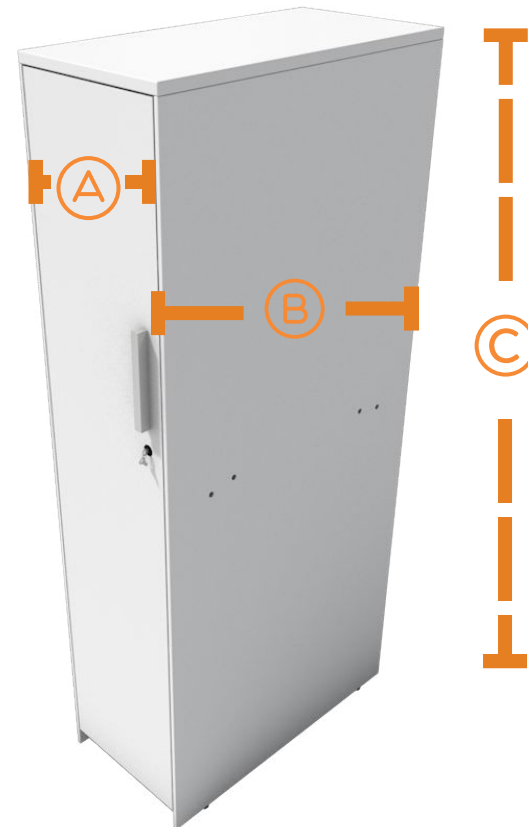

UNIVERSAL STORAGE CABINET

PRODUCT DIMENSIONS

(A) WIDTH
24in

(B) DEPTH
24in

(C) HEIGHT
53in

IN-STOCK / ACCESSORY FINISHES

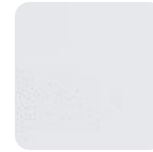

White



Walnut



Grey Fog



Storm Grey

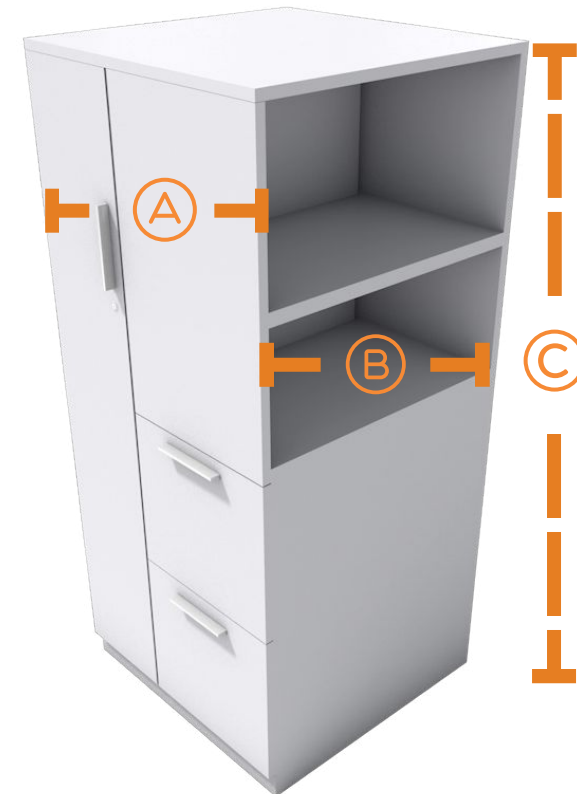

UNIVERSAL BOX-FILE MOBILE STORAGE

PRODUCT DIMENSIONS

(A) WIDTH
16in

(B) DEPTH
22in

(C) HEIGHT
22in

IN-STOCK / ACCESSORY FINISHES

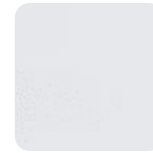

White



Walnut



Grey Fog



Storm Grey

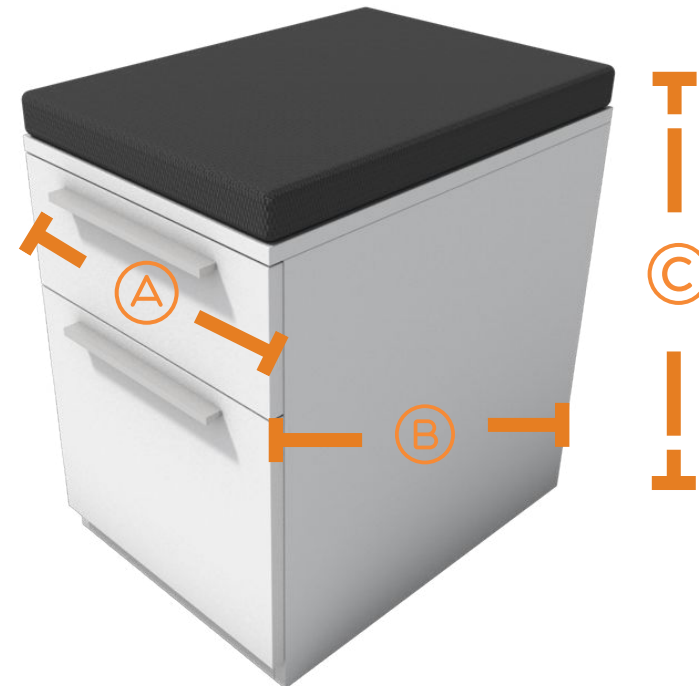

UNIVERSAL FILE-FILE STORAGE

PRODUCT DIMENSIONS

(A) WIDTH
16in

(B) DEPTH
23in

(C) HEIGHT
28in

IN-STOCK / ACCESSORY FINISHES

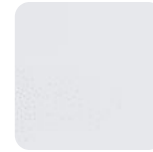

White



Walnut



Grey Fog



Storm Grey



WORKSTATION ACCESSORIES

SELECT ACCESSORIES



Hanging
Shelf



Overhead
Storage Cabinet

IN-STOCK / ACCESSORY FINISHES

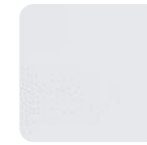

White



Walnut



Grey Fog



Storm Grey

HANGING SHELF

PRODUCT DIMENSIONS

(A) WIDTH
35in

(B) DEPTH
6in

(C) HEIGHT
14in

IN-STOCK / ACCESSORY FINISHES

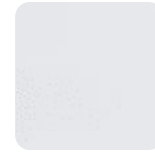

White



Walnut



Grey Fog



Storm Grey

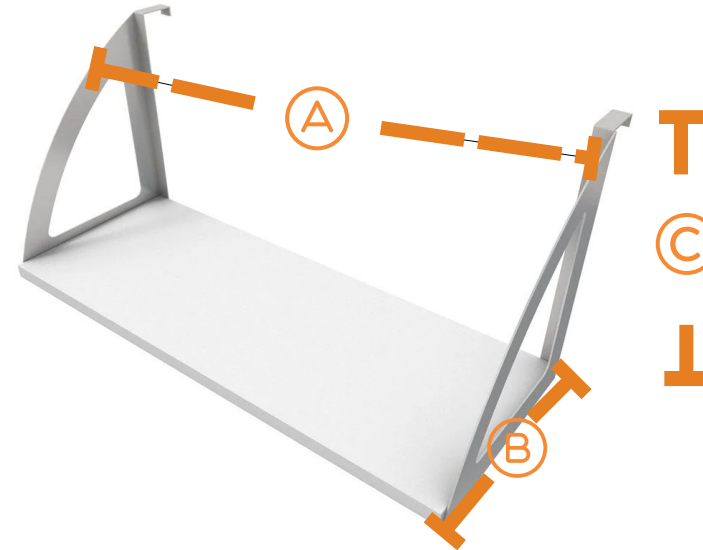

OVERHEAD CABINET

PRODUCT DIMENSIONS

(A) WIDTH
35in

(B) DEPTH
14in

(C) HEIGHT
17in

IN-STOCK / ACCESSORY FINISHES

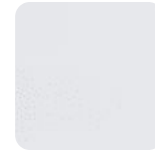

White



Walnut



Grey Fog



Storm Grey

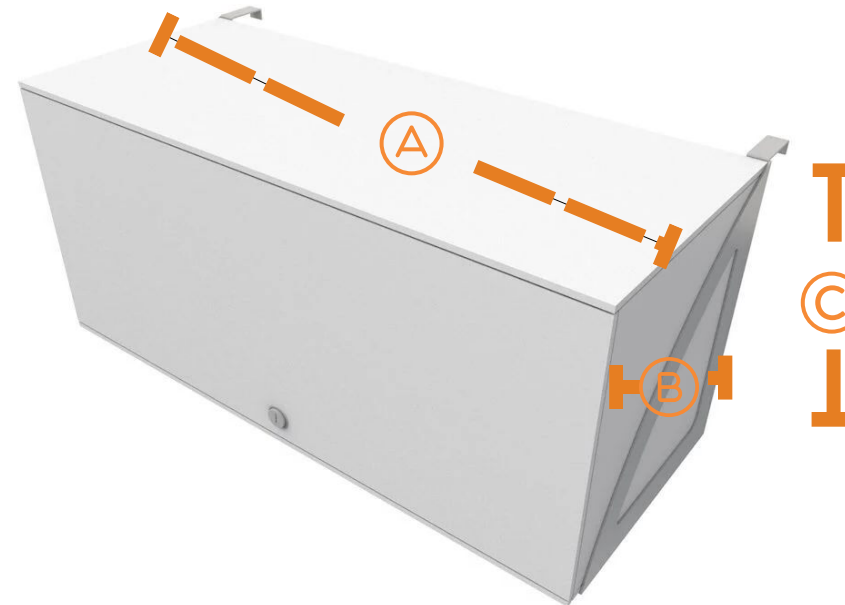

53" HIGH ENVIRONMENT IMAGES

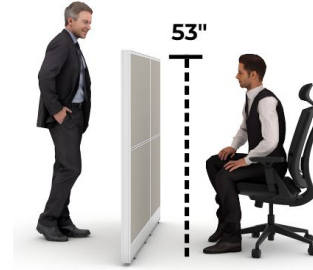

65" HIGH ENVIRONMENT IMAGES

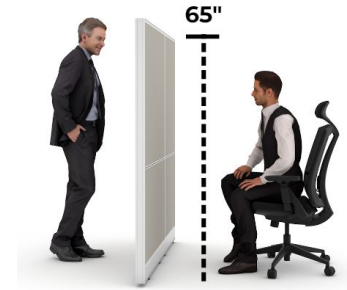

WORKSTATION

KEY FEATURES

- **Modern Aesthetic:** Sleek, monolithic workstations with a segmented design—ideal for crafting a professional and welcoming workspace.
- **Extensive Color and Finish Options:** Multiple finishes and color options for a tailored aesthetic.
- **Premium Materials:** Constructed from high-quality anodized aluminum with horizontal support rails added for strength and rigidity.
- **User-Friendly Assembly:** Panels snap together effortlessly, secured with just a few clips and screws, making office setup quick and hassle-free.
- **Customizable Configurations:** Build a wide variety of configurations using 2' and 3' panels, including options such as 4'x2', 5'x5', 6'x6', 8'x6', 8'x8', and more.
- **Cost-Efficient:** Our system is priced 30-50% lower than other comparable new cubicle systems on the market.
- **Storage and Accessories:** A variety of storage and accessory options are available to enhance the functionality of your cubicle setup.
- **Comprehensive Support:** Expert support for layout planning and customization, with dedicated customer service for product guidance and solutions.
- **Trusted Brand:** We have over 90 years of experience in office furniture solutions.

SUNLINE

FREQUENTLY ASKED QUESTIONS

FREQUENTLY ASKED QUESTIONS

Q: Are the panels non-tackable and non-acoustical? Do they have an STC rating and/or NRC rating?

A: Our in-stock Sunline Select panels are non-tackable; however, if you're interested in tackable panels, we can special order them from our factory. They have a .35 NRC rating. No STC rating.

Q: What is the fiber content of the panel fabric?

A: Sunline Select panels are Polyester.

Q: Is panel fabric Class A?

A: Sunline Select panels are Class A.

Q: What is its colorfastness etc.?

A: Sunline Select - Grade 4

Q: What panel widths are available?

A: Sunline Select In-Stock Panel Widths: 24", 36", 39", and 48"

Sunline Select Factory Order Panel Widths: 24", 30", 36", 42", 48", and 60" *custom sizes upon request

Q: What are the worksurfaces made of? What is the worksurface thickness?

A: Our worksurfaces are LPL (low pressure laminate) with a vinyl edge. The thickness of the worksurface is 25mm (1"). The vinyl edge is 2mm (.08") thick.

FREQUENTLY ASKED QUESTIONS

Q: What is the grommet situation like? In some views, it appears there is a corner grommet only.

A: We have surfaces with and without grommets. Surfaces with grommets typically come with one corner grommet and all our corner worksurfaces have one grommet in the far back corner.

Q: Does the Sunline Select System have belt line power?

A: Yes, Sunline Select has the ability to run power in other locations in addition to the raceway. This can be done either integrated in the panel system or by a desk top mounted power device.

Q: Is all electrical UL listed?

A: Yes, our electrical components are UL listed.

Q. What storage options do you have to offer and what material are they made of?

A. All of our storage options are low pressure laminate. We have :

- | | | |
|-------------------------------------|-----------------------------|-----------------------|
| ▪ Standing desk base | ▪ Wardrobe cabinet | ▪ Hanging shelf |
| ▪ Full height box/box/file | ▪ Storage tower | ▪ Transaction top |
| ▪ Full height file/file | ▪ Low credenza side storage | ▪ LM dual monitor arm |
| ▪ Mobile box/file with seat cushion | ▪ Overhead storage cabinet | ▪ Desktop sit-stand |
| ▪ 2-drawer lateral file | ▪ Overhead tasklight | |

Q: Do you have the ability to key alike?

A: Yes, keyed and alike, with master key available - full key program.

FREQUENTLY ASKED QUESTIONS

Q: Do you offer design services?

A: Yes, we provide complimentary design services to customers who purchase office cubicles from us, streamlining the process of creating an optimal workstation layout. Share your floor plan, along with your specific requirements and preferences, and our experienced team will craft customized design options using advanced CAD technology. Collaboratively, we will finalize a workspace layout that aligns with your vision and transforms your office into a functional and inspiring environment.

Q: What are your in-stock fabric options?

A: Sunline Select in-stock fabric options:



In-Stock:
Greige

Q: What are your in-stock surface finish options?

A: Sunline Select in-stock finish options:



White



Walnut



Grey Fog



Storm Grey

WORKSTATION CERTIFICATIONS

The Sunline Select system meets the following standards:

ISO14001/9001/45001



CFCC



PEFC



*Certificates available upon request

SUNLINE

CONTACT

313 W 4th Street
Bridgeport, PA 19405

PHONE:
610.272.2050



HOURS

24/7 Sales Availability

SHOWROOM HOURS

Monday - Friday
8:30 am - 6:00 pm EST

*Weekends by appointment

